

1 |

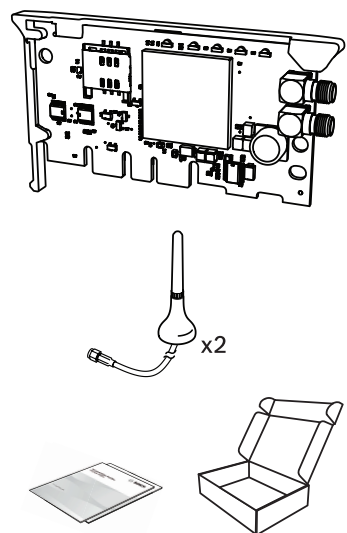

2 |

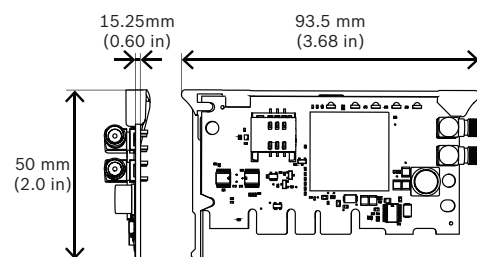

1:2

3 |

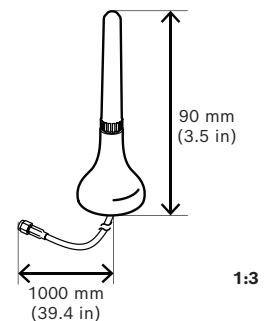

1:3

Non-condensing		12v .....	
	UL	$\updownarrow$	93% 0%
	UL	$\updownarrow$	49 °C } +120°F 0 °C } +32°F
Standby		35mA	
Maximum		85mA	

4 |

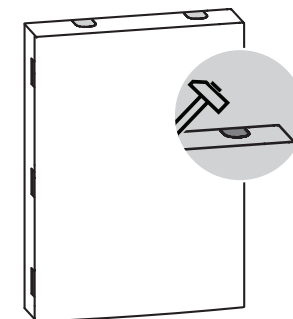

5 |

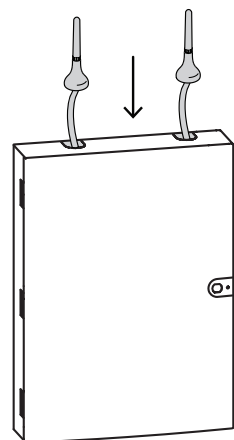

6 |

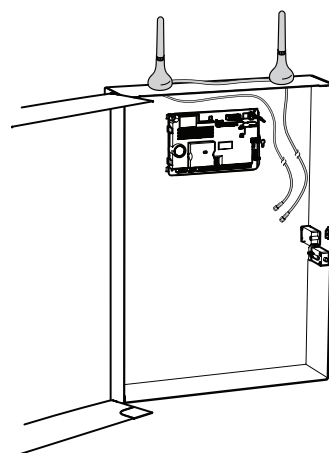

7 |

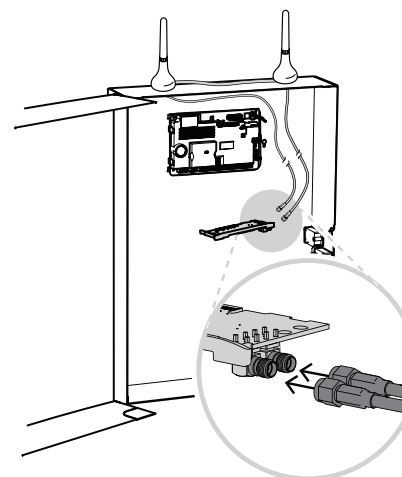

8 |

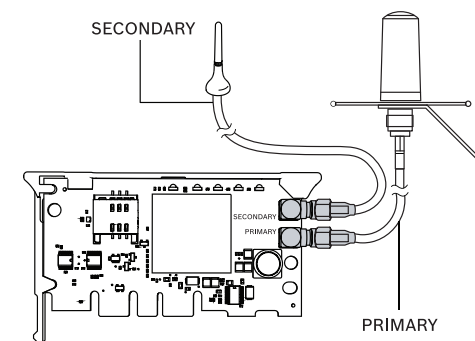

! The B40 must be installed to the Primary connector.

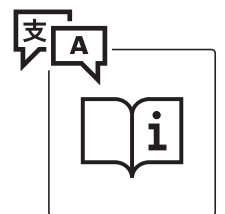
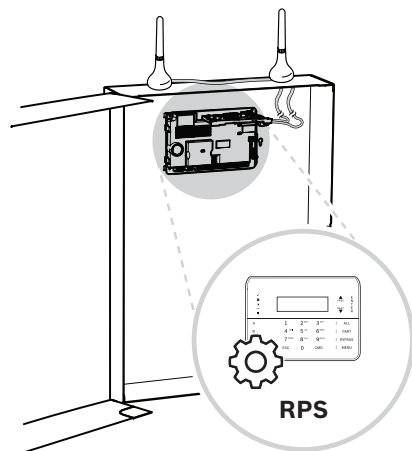
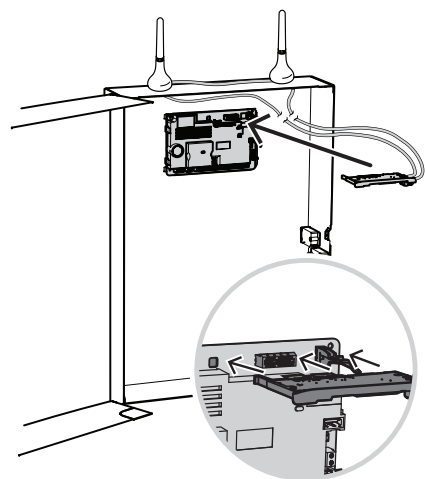

[www.boschsecurity.com](http://www.boschsecurity.com)

## B444

B444-A | B444-V

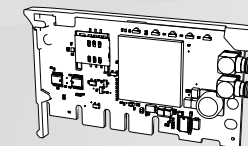

en Quick Installation Guide

### Manufacturing dates

For product manufacturing dates, go to <http://www.boschsecurity.com/datecodes/> and refer to the serial number located on the product label.

### Trademarks

All hardware and software product names used in this document are likely to be registered trademarks and must be treated accordingly.

### Bosch Security Systems B.V.

Torenallee 49  
5617 BA Eindhoven  
The Netherlands

[www.boschsecurity.com](http://www.boschsecurity.com)

© Bosch Security Systems B.V., 2020